

 Sandberg®

# Powerbank 10000 PD20W+Wireless

Quick guide

420-61



[www.sandberg.world](http://www.sandberg.world)

## Charge Powerbank

Charge by USB-C or Micro USB

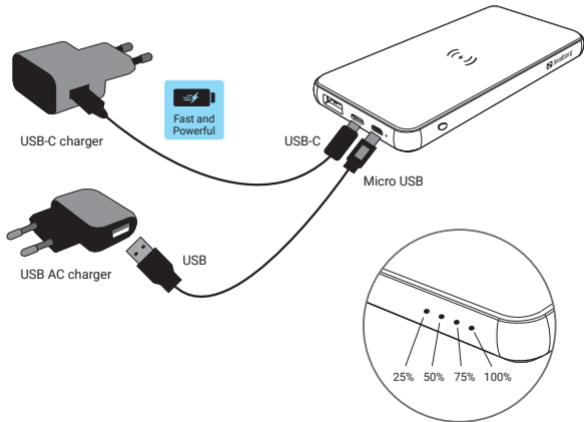

## Charge devices

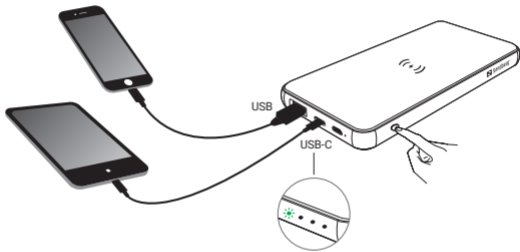

## Wireless charger

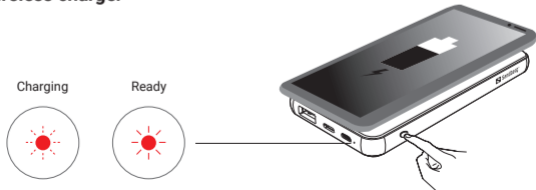



**Support**

*<http://helpdesk.sandberg.world>*

## **Warranty**

*There is a five-year warranty on your Sandberg product.  
Please read the warranty terms and register your new  
Sandberg product at [www.sandberg.world/warranty](http://www.sandberg.world/warranty)*

**5**  
Years  
Warranty

For information on handling electronic waste, see [www.sandberg.world/weee](http://www.sandberg.world/weee)

